

CaWrap UV 200 (SK)

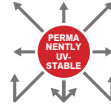

CE 13

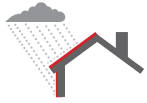

According EN 13859-2:2010

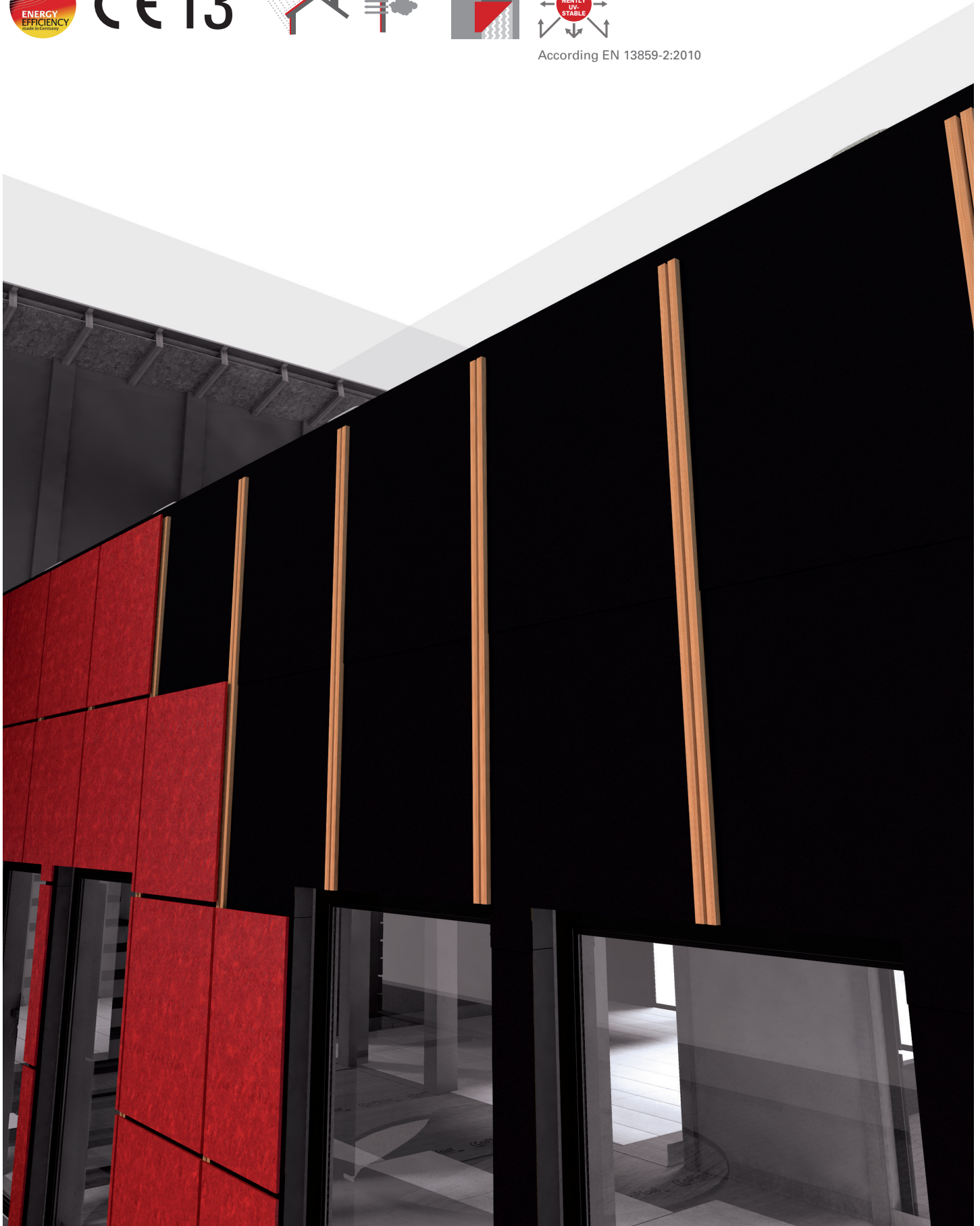

CaWrap UV 200 (SK)

SYSTEMATIC SAFETY AND ENERGY EFFICIENCY

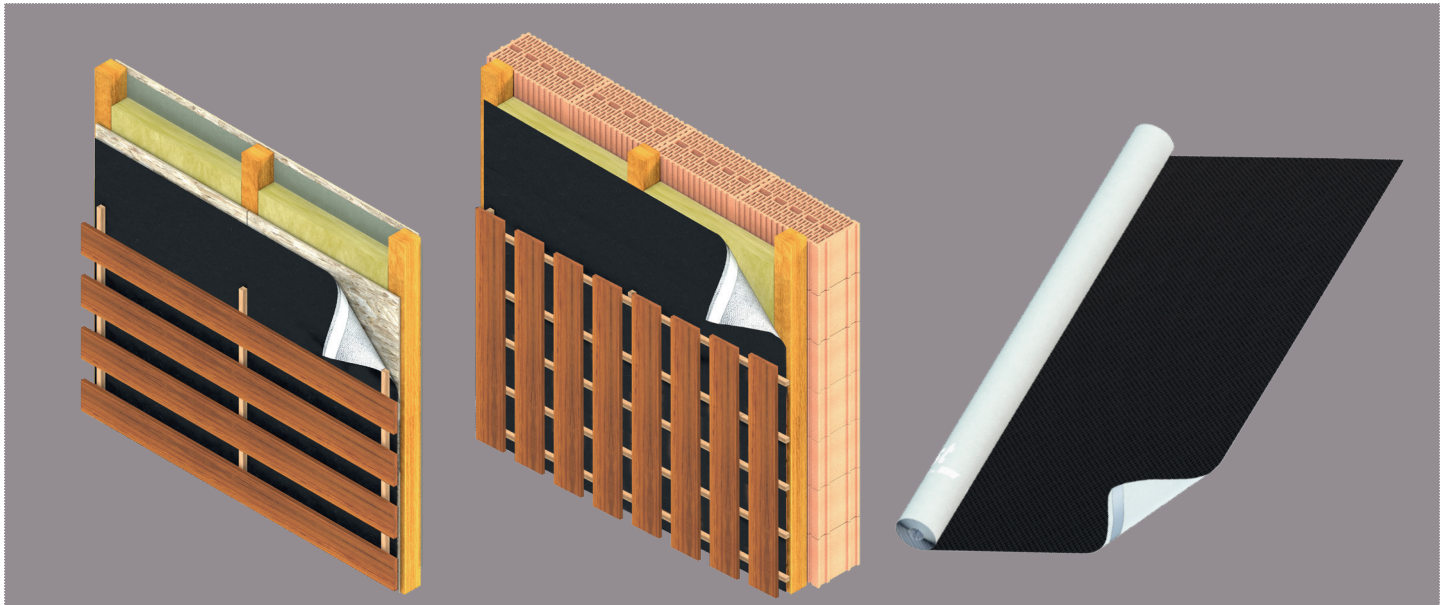

CaWrap UV 200 SK consists of a PES non-woven material and an innovative, diffusion permeable polyurethane coating, which provides long-lasting UV protection. Driving rain or snow are effectively kept out by the insulating layer. The smooth surface of the façade membrane allows incident or infiltrating moisture to safely and securely run off. This membrane is also available without self adhesive strips as CaWrap UV 200.

The latest versions of the ZVDH technical specifications, the CaPlast processing instructions, the relevant standards and the requirements of the GEG (Building Energy Law) and other applicable directives must be observed during processing. The specifications of DIN 18516-1 must be observed and implemented in all cases. The use as UDB / USB is possible by special contractual agreement.

We reserve the right to make technical modifications in the interests of progress or for production-related reasons.

The declaration of performance, the CE technical data sheet and further information can be found at www.caplast.de.

FIELDS OF APPLICATION

For all non-bearing, rear ventilated façades

Maximum proportion of joints 40% and a maximum joint width of 50 mm

BENEFITS

High level of UV resistance

High levels of openness

Protects the insulation from flying snow and driving rain

Moisture that accrues can be channelled away securely

Quick and cost-effective to work with

Wind resistant surface

Black surface

TECHNICAL DATA

EN 13859-2

Weight (g/m ²)	220 ± 10%
Building material	E
Resistance to water penetration	W 1
s _d -value (m)	0.13 ± 0.03
Tear resistance L/T (N/5 cm)	300/340 ± 30
Elongation L/T (%)	50/60 ± 15
Nail tear resistance L/T (N)	200/185 ± 20
Resistance to water pressure (cm WS)	> 400
Temperature resistance (°C)	- 40 to + 80
Outdoor exposure (UV)	with a 10-year warranty*
Roll width/Roll length (m)	1.50/50 3.00/50

* Applies only to part open façade membranes with a joint proportion of 40% and a maximum joint width of 50 mm.